



QUICK OPENING & CLOSING HEAD
Easy to replace die sets.

D31

MANUAL HYDRAULIC CRIMPING TOOL

> Identical force, stroke and capacities as the battery operated tools BPE031 & BPL031.

HEXAGONAL CRIMPING
4 > 95 mm²



THE MOST COMPACT TOOL ON THE MARKET
Ideal for crimping LV/MV lugs.



NARROW HEAD
To work in switchboards.



LIGHT & ERGONOMIC
One hand crimping.

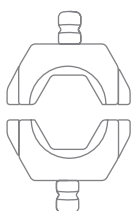

Die sets
4 > 95 mm²

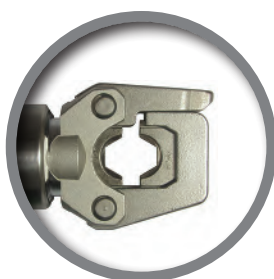

DIE SETS – Refer to **PAGES 88 – 96**.

> Common interchangeable die sets for **D31, BPE031 & BPL031** tools.

STROKE	8 mm
FORCE	35 kN
DIMENSIONS (L x l x h in mm)	200 x 50 x 175
WEIGHT	1.320 kg

APPLICATIONS	SECTIONS
Copper lugs and sleeves – NFC 20-130	4 > 95 mm ²
Bare or insulated sleeves in copper or alu – EDF	E54 > E173
Copper or alu lugs and sleeves – DIN 48083	KZ4 > KZ18
C-shaped connectors	C6 > C16
Copper lugs and sleeves – NFC 20-130	10 > 70 mm



DIMENSIONS (mm)	350 x 260 x 85
WEIGHT	0.700 kg

> Delivered with the tool.